



UNIVERSITY OF NEBRASKA AT OMAHA SCOTT CAMPUS PARKING MAP

UPDATED 06/12/18



TO DODGE CAMPUS (0.75 MILES)
18 MIN WALK | 5 MIN BIKE

PACIFIC STREET

PINE STREET

72ND STREET

67TH STREET

72ND STREET

AKSARBE DRIVE

67TH STREET

SHIRLEY STREET

TO CENTER CAMPUS (0.70 MILES)
14 MIN WALK | 5 MIN BIKE

- NEWMAN RESIDENT
- STUDENT
- F/S/S SURFACE PERMITS
- VISITOR (NO UNO)
- FACULTY
- SCOTT RESIDENT
- RESERVED

- A Peter Kiewit Institute (PKI)
- B Mammel Hall (MH)
- C Scott Residence Hall (SRH)
- D Scott Conference Center (SCC)
- E Scott Village (SV)
- F Scott Court (SC)
- G Scott Technology Center (STC)
- H Pacific Street Garage (PSG)
- I Parking Services (PS)
- J Newman Center (NC)
- K Maverick Landing/Scott Crossing

- C CARPOOL
- K KIOSKS
- BICYCLE RACKS
- PO PARK OMAHA
- HANDICAP PARKING
- MOTORCYCLE PARKING
- EV CHARGING STATION

Permits Required

Faculty/Staff/Stud. Surface Lots: 7 A.M. to 7 P.M. (M-TH)

Garage: 7 A.M. to 7 P.M. (M-TH)

UNIVERSITY OF
Nebraska
Omaha

402.554.2800 | unomaha.edu

THIS IS A SMOKE- AND TOBACCO-FREE CAMPUS AS OF 8/22/16

* Parking permit types are assigned to specific surface lots, garages, and/or garage levels. It is the responsibility of the permit holder to know which designated areas their permit is valid in.



UNIVERSITY OF NEBRASKA AT OMAHA DODGE CAMPUS PARKING MAP

UPDATED 06/12/18



- 1 Allwine Hall (AH)
- 2 Arts & Sciences Hall (ASH)
- 3 Biomechanics Research Building (BRB)
- 4 Caniglia Field (CF)
- 5 Central Utilities Plant (CUP)
- 6 Child Care Center (CCC)
- 7 College of Public Affairs & Community Service (CPACS)
- 8 Barbara Weitz Community Engagement Center (Weitz CEC)
- 9 Criss Library (CL)
- 10 Durham Science Center (DSC)
- 11 East Parking Garage (EPG)
 - Lot T - Lower Level
 - Lot U - Middle Level
 - Lot V - Upper Level
- 12 Eppley Administration Building (EAB)
- 13 Health & Kinesiology Building (H&K)
- 14 Henningson Memorial Campanile (HMC) (clock tower)
- 15 Kayser Hall (KH)
- 16 Landscape Services (LS)
- 17 Maverick Village (MV)
- 18 Milo Bail Student Center (MBSC)
- 19 Pep Bowl (open space)
- 20 Resource Conservation & Recovery Area (RCRA)
- 21 Roskens Hall (RH)
- 22 Sapp Fieldhouse (SFH)
- 23 Sculpture & Ceramics Studio (SCS)
- 24 Strauss Performing Arts Center (SPAC)
- 25 Thompson Alumni Center (TAC)
- 26 University Village (UV)
- 27 Weber Fine Arts Building (WFAB)
- 28 Welcome Center (WC)
- 29 West Parking Garage (WPG)



Permits Required

Faculty/Staff/Stud. Surface Lots: 7 A.M. to 7 P.M. (M-TH)
7 A.M. to 5 P.M. (F)
Garages: 7 A.M. to 7 P.M. (M-TH)

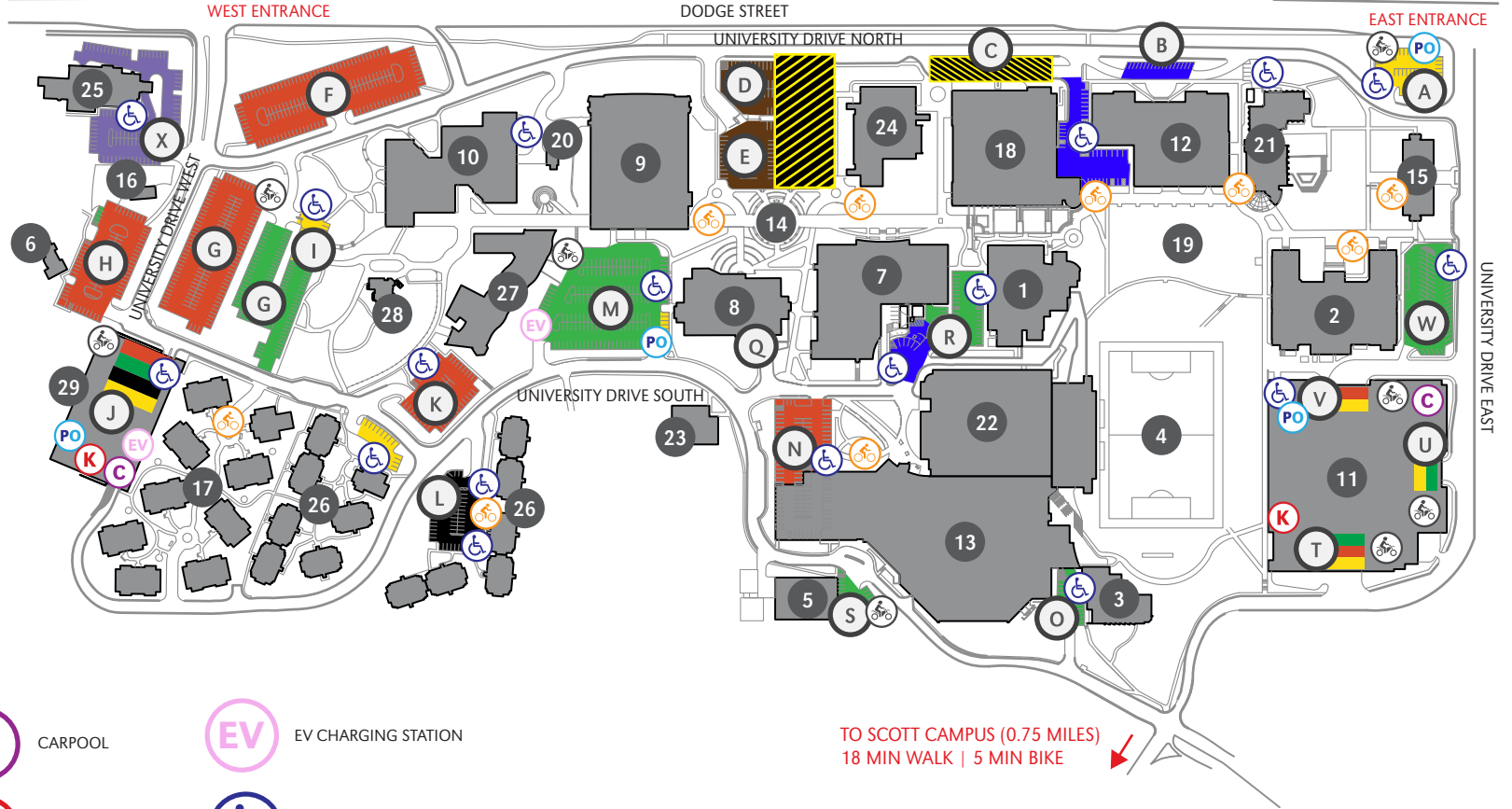
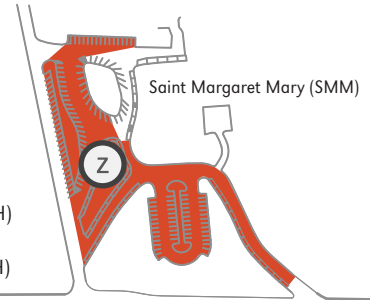

- STUDENT**
- F/S/S SURFACE PERMITS**
- VISITOR (NO UNO)**
- FACULTY**
- RESERVED**
- EVENT PARKING**
- CEC VISITOR**
- MV/UV RESIDENT**
- CLOSED LOTS**

- C** CARPOOL
- EV** EV CHARGING STATION
- K** KIOSKS
- EV** EV CHARGING STATION
- Handicap icon** HANDICAP PARKING
- Bicycle icon** BICYCLE RACKS
- Motorcycle icon** MOTORCYCLE PARKING
- PO** PARK OMAHA

TO SCOTT CAMPUS (0.75 MILES)
18 MIN WALK | 5 MIN BIKE

UNIVERSITY OF
Nebraska
Omaha

402.554.2800 | unomaha.edu

THIS IS A SMOKE- AND TOBACCO-FREE CAMPUS AS OF 8/22/16

* Parking permit types are assigned to specific surface lots, garages, and/or garage levels. It is the responsibility of the permit holder to know which designated areas their permit is valid in.